

COORDINATES BASED ON PEI DOUBLE TERZO - COORDINATES EXPRESSED IN FEET

STA	EASTING	NORTHING	STA	EASTING	NORTHING
401	385174.74	439449.96	432	385999.66	440107.63
402	386001.37	439740.41	433	385955.52	440112.66
403	386313.44	439666.94	434	385909.54	440098.37
404	386320.42	439101.34	435	385844.80	439729.48
405	386241.85	438496.99	436	385777.98	439382.83
406	386021.85	437702.98	437	385702.98	439057.43
407	385924.51	436924.51	438	385628.02	438757.43
408	385924.51	436924.51	439	385553.02	438482.43
409	385924.51	436924.51	440	385478.02	438229.43
410	385924.51	436924.51	441	385403.02	437997.43
411	385924.51	436924.51	442	385328.02	437786.43
412	385924.51	436924.51	443	385253.02	437596.43
413	385924.51	436924.51	444	385178.02	437426.43
414	385924.51	436924.51	445	385103.02	437276.43
415	385924.51	436924.51	446	385028.02	437146.43
416	385924.51	436924.51	447	384953.02	437036.43
417	385924.51	436924.51	448	384878.02	436946.43
418	385924.51	436924.51	449	384803.02	436876.43
419	385924.51	436924.51	450	384728.02	436826.43
420	385924.51	436924.51	451	384653.02	436796.43
421	385924.51	436924.51	452	384578.02	436786.43
422	385924.51	436924.51	453	384503.02	436796.43
423	385924.51	436924.51	454	384428.02	436826.43
424	385924.51	436924.51	455	384353.02	436876.43
425	385924.51	436924.51	456	384278.02	436946.43
426	385924.51	436924.51	457	384203.02	437036.43
427	385924.51	436924.51	458	384128.02	437146.43
428	385924.51	436924.51	459	384053.02	437276.43
429	385924.51	436924.51	460	383978.02	437426.43
430	385924.51	436924.51	461	383903.02	437596.43
431	385924.51	436924.51	462	383828.02	437786.43
432	385924.51	436924.51	463	383753.02	437996.43
433	385924.51	436924.51	464	383678.02	438226.43
434	385924.51	436924.51	465	383603.02	438476.43
435	385924.51	436924.51	466	383528.02	438746.43
436	385924.51	436924.51	467	383453.02	439036.43
437	385924.51	436924.51	468	383378.02	439346.43
438	385924.51	436924.51	469	383303.02	439676.43
439	385924.51	436924.51	470	383228.02	440026.43
440	385924.51	436924.51	471	383153.02	440396.43
441	385924.51	436924.51	472	383078.02	440786.43
442	385924.51	436924.51	473	383003.02	441196.43
443	385924.51	436924.51	474	382928.02	441626.43
444	385924.51	436924.51	475	382853.02	442076.43
445	385924.51	436924.51	476	382778.02	442546.43
446	385924.51	436924.51	477	382703.02	443036.43
447	385924.51	436924.51	478	382628.02	443546.43
448	385924.51	436924.51	479	382553.02	444076.43
449	385924.51	436924.51	480	382478.02	444626.43
450	385924.51	436924.51	481	382403.02	445196.43
451	385924.51	436924.51	482	382328.02	445786.43
452	385924.51	436924.51	483	382253.02	446396.43
453	385924.51	436924.51	484	382178.02	447026.43
454	385924.51	436924.51	485	382103.02	447676.43
455	385924.51	436924.51	486	382028.02	448346.43
456	385924.51	436924.51	487	381953.02	449036.43
457	385924.51	436924.51	488	381878.02	449746.43
458	385924.51	436924.51	489	381803.02	450476.43
459	385924.51	436924.51	490	381728.02	451226.43
460	385924.51	436924.51	491	381653.02	451996.43
461	385924.51	436924.51	492	381578.02	452786.43
462	385924.51	436924.51	493	381503.02	453596.43
463	385924.51	436924.51	494	381428.02	454426.43
464	385924.51	436924.51	495	381353.02	455276.43
465	385924.51	436924.51	496	381278.02	456146.43
466	385924.51	436924.51	497	381203.02	457036.43
467	385924.51	436924.51	498	381128.02	457946.43
468	385924.51	436924.51	499	381053.02	458876.43
469	385924.51	436924.51	500	380978.02	459826.43

NOTE: SURVEY REFERENCED TO PEI GRID MONUMENT NOS. 1577 & 1938.

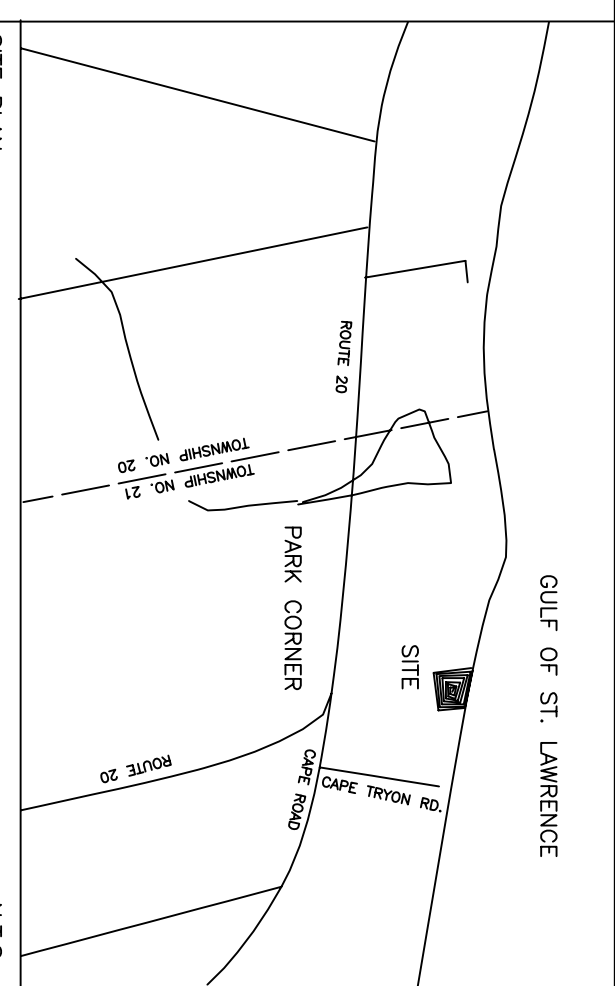

- LEGEND:
- LEGAL SURVEY MARKER SET
 - LEGAL SURVEY MARKER FOUND
 - ▬ BUILDING WALL
 - UNLIT POLE
 - LIT POLE
 - MAN HOLE
 - CATCHERBEN
 - FENCE
 - CALCULATED POINT

NOTES:

- ⊗ ALL MEASUREMENTS ARE IN FEET UNLESS OTHERWISE STATED.
- ⊗ REFER TO PLANS OF SURVEY PREPARED BY LOUIS SURVEYS LTD. DWG. NOS. 93752 & 03396.

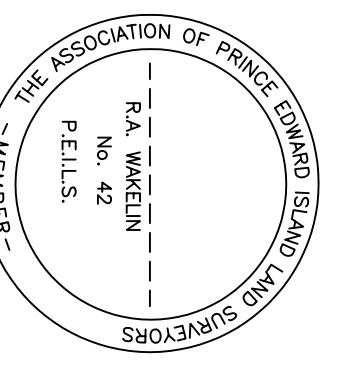

1. ROBERT A. WAGELIN, PRINCE EDWARD ISLAND LAND SURVEYOR, HAS REVIEWED THIS PLAN AND CONFIRMS THAT THIS PLAN IS A TRUE AND CORRECT REPRESENTATION OF THE SAID SURVEY.

PELLS

GULF SURVEYS LTD.

134 LONGWORTH AVENUE, CHARLOTTETOWN, P.E.I. C1A 8B3
 PHONE: (902) 566-1261, FAX: (902) 566-9275
 EMAIL: gulf@gsurveys.com

LOT 06-1 TO LOT 06-4

BEING A SUBDIVISION OF
**ALAN BRENNAN CALLED
 HAVEN AT PARK CORNER**

BEING PID NO. 90431
 PARK CORNER
 TOWNSHIP NO. 21
 QUEENS COUNTY
 QUEEN'S COUNTY

GRAPHIC SCALE - FEET

0 60 120 180

SURVEYED BY: R.A.W. & A.H.M. DATE DRAWN: SEPTEMBER 15, 2006
 DRAWN BY: R.A.W. REVISION: OCTOBER 6, 2006
 DATE SURVEYED: JULY 11, 2006 FILE NO.: 7355
 SCALE: 1"=60'